

BUILD YOUR NEW HOUSE **IN CLUBE ALBUFEIRA**

ALGARVE · PORTUGAL



CLUBE
ALBUFEIRA

GARDEN VILLAGE



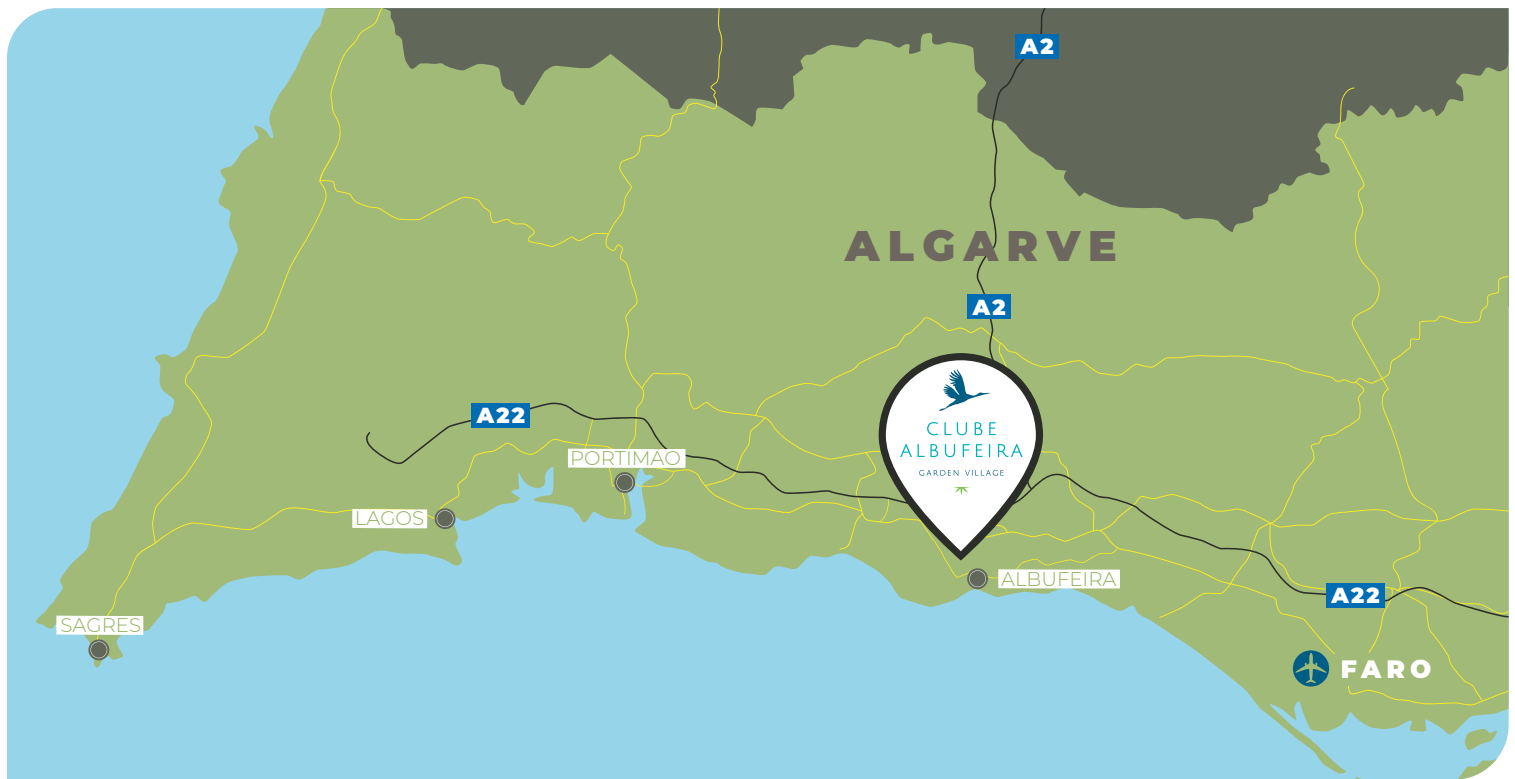

LOCALIZATION

Clube Albufeira Garden Village is located in Albufeira right in the heart of the Algarve and surrounded by lush greenery. This resort with unique features is the perfect location to build your dream villa and enjoy the peace and tranquility of this beautiful environment and is easily accessible from Faro airport (30 min) or from Lisbon (2 hours).

Albufeira is one of the most sought-after cities in the Algarve due to the beautiful beaches, wonderful climate, gastronomy, entertainment, sights and activities.



Located in Albufeira and surrounded by nature, this unique resort is the perfect location for building the house of your dreams in one of the land plots still available for purchase.

AVAILABLE LAND PLOTS

15	Plot Area: 906m ² Typology: T2 Floors: 2
16	Plot Area: 851m ² Typology: T2 Floors: 2
17	Plot Area: 836m ² Typology: T2 Floors: 2
31	Plot Area: 1404m ² Typology: T3 Floors: 2
36	Plot Area: 890m ² Typology: T2 Floors: 2
39	Plot Area: 958m ² Typology: T2 Floors: 1
42	Plot Area: 933m ² Typology: T2 Floors: 1
44	Plot Area: 948m ² Typology: T2 Floors: 1
45	Plot Area: 1191m ² Typology: T3 Floors: 1
46	Plot Area: 1053m ² Typology: T3 Floors: 1
47	Plot Area: 918m ² Typology: T2 Floors: 1
48	Plot Area: 990m ² Typology: T3 Floors: 1
54	Plot Area: 861m ² Typology: T2 Floors: 1
55	Plot Area: 1516m ² Typology: T3 Floors: 1
56	Plot Area: 1060m ² Typology: T3 Floors: 1
57	Plot Area: 980m ² Typology: T3 Floors: 1
58	Plot Area: 980m ² Typology: T3 Floors: 1
59	Plot Area: 899m ² Typology: T2 Floors: 1
60	Plot Area: 1114m ² Typology: T3 Floors: 1
61	Plot Area: 1222m ² Typology: T3 Floors: 1
62	Plot Area: 825m ² Typology: T2 Floors: 1
65	Plot Area: 1058m ² Typology: T3 Floors: 1
68	Plot Area: 1107m ² Typology: T3 Floors: 2
69	Plot Area: 1155m ² Typology: T3 Floors: 2
70	Plot Area: 1151m ² Typology: T3 Floors: 2
73	Plot Area: 1032m ² Typology: T3 Floors: 2
78	Plot Area: 1093m ² Typology: T3 Floors: 2
79	Plot Area: 1093m ² Typology: T3 Floors: 2
80	Plot Area: 1159m ² Typology: T3 Floors: 2
81	Plot Area: 1061m ² Typology: T3 Floors: 2



● Available
● Sold

ARCHITECTURAL SOLUTIONS

Our team of architects are available to help you transform your ideas into reality throughout the project.

Alternatively, you can also choose to purchase the plot with an already developed architecture solution. Find out more about these options below.

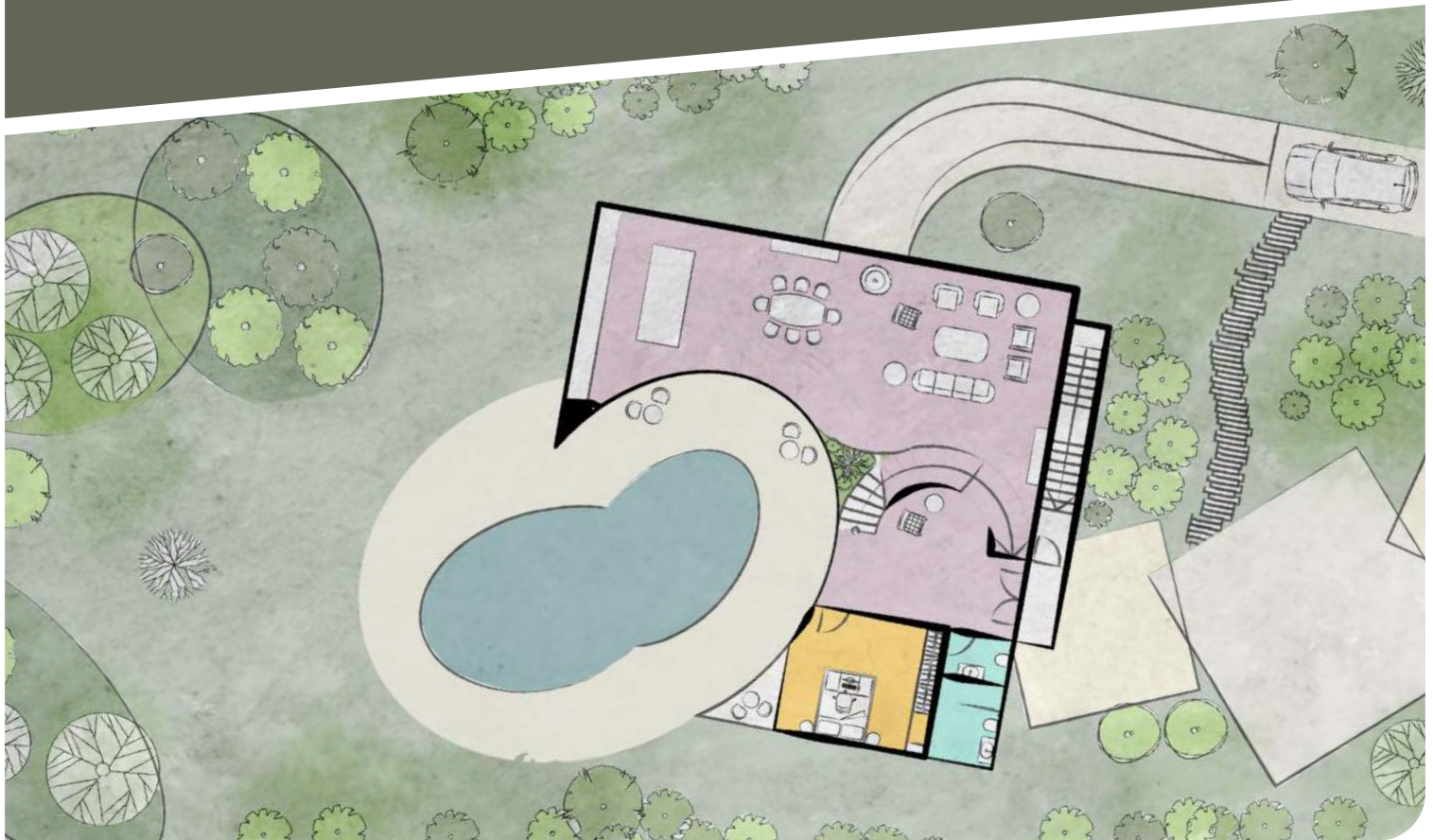

Our
Villa Oleander





LICENSING AND PROJECT MANAGEMENT

Our experienced project management team will be able to swiftly guide you throughout the whole project and also advise on the best solutions regarding building construction companies.



A high-angle photograph of a resort pool area. The pool is large and blue, with several smaller circular pools and a central island with a thatched roof. Numerous white lounge chairs and yellow umbrellas are arranged around the pool. In the background, white resort buildings are built into a hillside, surrounded by greenery and palm trees. The sky is clear and blue.

Our resort has reception facilities and security services available 24/7, is surrounded by beautiful gardens, has several restaurants, swimming pools and indoor and outdoor workout areas.

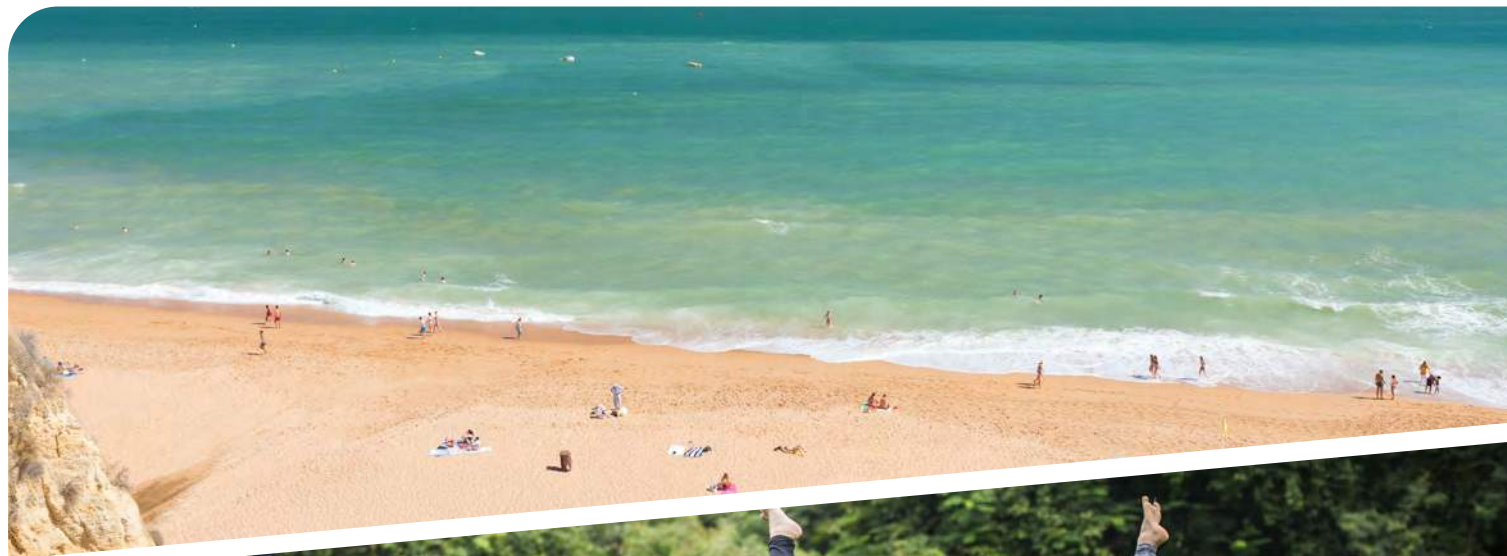



CONTACT US FOR MORE INFORMATION AND DETAILS

Clube Albufeira is not only a solid and good investment, but also the ideal location to enjoy a relaxed retirement, free time or your family holidays. Don't miss this opportunity for creating new memories and enjoying unforgettable moments. We look forward to your visit.



CLUBEALBUFEIRA.COM/REALESTATE
REALESTATE@CLUBEALBUFEIRA.COM
T. (+351) 914 933 853